

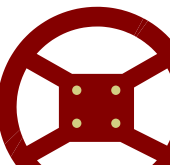

INDIAN AUTO COMPONENT INDUSTRY

May 2010

 ARE Research

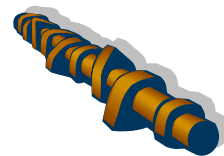
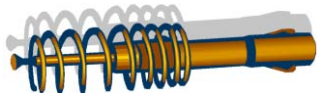

INDEX

EXECUTIVE SUMMARY	
I. OUTLOOK SECTION	
<ul style="list-style-type: none"> • Outlook on Domestic Market • Outlook on Exports • CARE Research's Demand Forecasting Model • Outlook on Profitability and Credit Profile 	
II. INDUSTRY SECTION	
1. INTRODUCTION <ul style="list-style-type: none"> • Size of the Auto Component Industry • Key Component Segments • Industry Structure and Competition • Importance to the Economy • Major Clusters • Government Policies – Customs Duty, Excise Duty Value Added Tax (VAT) / Sales Tax and Foreign Direct Investments (FDI) • Porter's Seven Force Analysis 	2. BUSINESS RISKS <ul style="list-style-type: none"> • This chapter deals with important and unique Business Risks, on which component manufacturers and sellers can be assessed and compared
	3. DOMESTIC MARKET <ul style="list-style-type: none"> • Size of the Domestic Market • Trend in the Domestic market • Original Equipment Manufacturers' Segment • Replacement Segment
4. EXPORTS <ul style="list-style-type: none"> • Trend in Exports • Key Markets • Key Products Exported • Challenges faced by exporters 	6. COST AND PROFITABILITY <ul style="list-style-type: none"> • Cost Structure <ul style="list-style-type: none"> • Raw Materials • Employee Costs • Power and Fuel Costs • Selling and Distribution Costs • Research and Development Costs • Profitability and Returns <ul style="list-style-type: none"> • EBIDTA Margins • Depreciation and Amortisation Costs • Asset Turn-over • Return on Capital Employed
5. IMPORTS <ul style="list-style-type: none"> • Size of Imports • Trend in Imports • Key Sources of Imports 	
7. CREDIT PROFILE <ul style="list-style-type: none"> • Gearing • Interest Coverage • Working Capital Cycle 	8. ANALYSIS OF INDUSTRY SEGMENTS <ul style="list-style-type: none"> • Engine Components • Drive Transmission and Steering Components • Body and Chassis • Suspension and Braking Components • Equipments • Electrical Components • Other Components

III. COMPANY SECTION

<ul style="list-style-type: none">• A N G Auto• Amtek Auto• Amtek India• Asahi India Glass• Autoline Industries• Automobile Corporation of Goa• Automotive Axles• Automotive Stampings & Assemblies• Banco Products (India)• Bharat Forge• Bharat Gears• Bosch• Bosch Chassis Systems• Ceekay Daikin• Clutch Auto• Delphi-T V S Diesel Systems• Denso India	<ul style="list-style-type: none">• Exide Industries• Federal-Mogul Goetze• Fiem Industries• G K N Driveline• Gabriel India• Halonix• Harita Seating Systems• Hi-Tech Gears• India Pistons• J B M Auto• J M T Auto• Jamna Auto Inds.• Jay Bharat Maruti• L G Balakrishnan & Bros.• Lucas-TVS• Lumax Industries	<ul style="list-style-type: none">• Minda Corporation• Motherson Sumi Systems• Munjal Auto Inds.• Munjal Showa• Omax Autos• Pricol• Rane (Madras)• Rico Auto Inds.• Sona Koyo Steering Systems• Subros• Sundaram Brake Linings• Sundaram-Clayton• Talbros Automotive Components• Talbros Engineering• Ucal Fuel Systems• Wheels India• Z F Steering Gear
---	---	--

IV ANNEXURES

<ul style="list-style-type: none">• 10 Year Trend in Domestic Auto Component Production• 10 Year Trend in Domestic Auto Component Market by Segment• 10 Year Trend in India's Auto Component Exports• 10 Year Trend in India's Auto Component Imports• 10 Year Trend in Investments in India's Auto Component Industry• 5 Year Trend in Key Financial Indicators of the Auto Component Industry• 10 Year Trend in Domestic Automobile Production by Segment• 10 Year Trend in Domestic Automobile Sales by Segment• 10 Year Trend in India's Automobile Exports by Segment• 10 Year Trend in India's Automobile Population by Segment
--

According to **CARE Research**, buoyant economic outlook and lower penetration level would drive domestic automobile sales. Low cost base would drive automobile exports from India. This in turn would translate into healthy growth for the ancillary auto component industry in the next 4 – 5 years. The low cost advantage would also drive component exports from India. The advantages of abundant low cost labour, local availability of steel, aluminium and natural rubber as well as strong ancillary industry in addition to the 100 per cent FDI allowed in the sector has attracted global auto majors to set up significant capacities in India. The investments in component manufacturing is replicating this trend. Many global auto manufacturers are not only sourcing components from local players for their India operations but also for their overseas production. In many other cases, the global automobile manufacturers are setting up component manufacturing facilities in India for their Indian as well as overseas operations. Thus, India is not only eyed as the hub for automobile production but also the epicentre to source components as well.

The report is divided into four sections. Section I presents **CARE Research's** outlook on industry that covers domestic and export sales forecasts for the next five years and outlook on the profitability and credit profile for next two years. Section II provides an in-depth study of the Indian Auto Component industry encompassing the size, characteristics, trends, Government regulations, demand, supply, competition, cost structure, profitability and credit profile. Section III provides profile of 50 key players, while Section IV contains various key data tables as an Annexure to the report.

I. Outlook Section

- An executive summary is provided that briefly provides CARE Research's opinion on the industry
- Outlook on domestic market provides five year forecasted domestic auto component sales.
- Outlook on exports provides five year forecasted auto component exports.
- Description of **CARE Research's** demand forecasting methodology
- Outlook on profitability and credit profile.

II. Industry Section

- Introduction to the industry, including the size of the industry, key segments, industry structure and competition, importance to the economy, major clusters, Government Policies – Customs Duty, Excise Duty Value Added Tax (VAT) / Sales Tax and Foreign Direct Investments (FDI) and Porter's Seven Force Analysis
- Detailed analysis of historical trends for both domestic as well as export market.
- Trends in imports and key sources of origin.
- Analysis of the cost structure, profitability and credit profile of the industry.
- Analysis of various segments of the industry, namely engine components, drive transmission & steering components, body & chassis, suspension & braking components, equipments, electrical components and others.

III. Company Section

- This section provides the profiles of 50 key players:
 - A N G Auto
 - Amtek Auto
 - Amtek India
 - Asahi India Glass

- Autoline Industries
- Automobile Corporation of Goa
- Automotive Axles
- Automotive Stampings & Assemblies
- Banco Products (India)
- Bharat Forge
- Bharat Gears
- Bosch
- Bosch Chassis Systems
- Ceekay Daikin
- Clutch Auto
- Delphi-T V S Diesel Systems
- Denso India
- Exide Industries
- Federal-Mogul Goetze
- Fiem Industries
- G K N Driveline
- Gabriel India
- Halonix
- Harita Seating Systems
- Hi-Tech Gears
- India Pistons
- J B M Auto
- J M T Auto
- Jamna Auto Inds.
- Jay Bharat Maruti
- L G Balakrishnan & Bros.
- Lucas-TVS
- Lumax Industries
- Minda Corporation
- Motherson Sumi Systems
- Munjal Auto Inds.
- Munjal Showa
- Omax Autos
- Pricol
- Rane (Madras)
- Rico Auto Inds.
- Sona Koyo Steering Systems
- Subros

- Sundaram Brake Linings
- Sundaram-Clayton
- Talbros Automotive Components
- Talbros Engineering
- Ucal Fuel Systems
- Wheels India
- Z F Steering Gear

IV. Annexure

- 10 Year Trend in Domestic Auto Component Production
- 10 Year Trend in Domestic Auto Component Market by Segment
- 10 Year Trend in India's Auto Component Exports
- 10 Year Trend in India's Auto Component Imports
- 10 Year Trend in Investments in India's Auto Component Industry
- 5 Year Trend in Key Financial Indicators of the Auto Component Industry
- 10 Year Trend in Domestic Automobile Production by Segment
- 10 Year Trend in Domestic Automobile Sales by Segment
- 10 Year Trend in India's Automobile Exports by Segment
- 10 Year Trend in India's Automobile Population by Segment

For an in-depth understanding and analysis of the Indian Auto Component Industry and CARE Research's outlook on the sector with its forecast of domestic sales as well as exports for each year till 2014-15 and other key trends in the industry foreseen, please refer to the Report on the *Indian Auto Component Industry, May 2010* by CARE Research.

The subscription to this report includes half yearly updates and any other releases, including Impact reports on the Indian Auto Component Industry for the next 1 year from the date of subscription.

Kindly click on the link below to subscribe a copy of the same

<http://www.careratings.com/content/ResourceCenter/IndustryReport.aspx>

For any queries regarding the content and scope of the report kindly reach us at

careresearch@careratings.com

Ms. Revati Kasture

revati.kasture@careratings.com

Head – Industry Research

(D): +91-22-6754 3465

Mr. Dhimant Kothari

dhimant.kothari@careratings.com

Manager

(D): +91-22-6754 3479



CREDIT ANALYSIS & RESEARCH LTD.

4th Floor Godrej Coliseum, Off Eastern Express Highway,

Somaiya Hospital Road, Sion East, Mumbai – 400 022.

Tel: +91-22-6754 3456 Fax: +91-22-6754 3457

All Rights Reserved. No part of this report may be reproduced or transmitted in any form without prior written permission from CARE

DISCLAIMER

This report is prepared by CARE Research, a division of Credit Analysis & REsearch Limited [CARE]. CARE Research has taken utmost care to ensure accuracy and objectivity while developing this report based on information available in public domain. However, neither the accuracy nor completeness of information contained in this report is guaranteed. CARE Research operates independently of ratings division and this report does not contain any confidential information obtained by ratings division, which they may have obtained in the regular course of operations. The opinion expressed in this report cannot be compared to the rating assigned to the company within this industry by the ratings division. The opinion expressed is also not a recommendation to buy, sell or hold an instrument.

CARE Research is not responsible for any errors or omissions in analysis/inferences/views or for results obtained from the use of information contained in this report and especially states that CARE (including all divisions) has no financial liability whatsoever to the user of this product. This report is for the information of the intended recipients only and no part of this report may be published or reproduced in any form or manner without prior written permission of CARE Research.

Published by Credit Analysis & REsearch Ltd. 4th Floor Godrej Coliseum, Off Eastern Express Highway, Somaiya Hospital Road, Sion East, Mumbai – 400 022. Tel:+91- 22-6754 3456 Fax:+91-22-6754 3457